

se'lux offer a comprehensive range of high quality luminaires. Innovative fixtures designed to help architects and designers create exceptional spaces to live and work. To find out more about the complete range of se'lux fixtures please contact us:



www.selux.com

Germany Headquarters
Semperlux Aktiengesellschaft
Lichttechnische Werke
Motzener Str. 34
D-12277 Berlin
Tel +49 (30) 720 01-0
e-mail: info@selux.de

Asia
Tel.: +65 6 270 97 73
e-mail: selux.asia@pacific.net.sg

Austria
Tel.: +43 (0)1 615 46 90
e-mail: office@selux.at

Australia/New Zealand
Tel.: +61 (2) 99 72 77 27
e-mail: info@selux.com.au

Belgium
Tel.: +32 (3) 448 30 37
e-mail: info@selux.be

Canada
Tel.: +1 (845) 691 77 23
e-mail: seluxus@selux.com

Czech Republic
Tel.: + 420-543215566
email: info@profilux.cz

Finland
Tel.: +358 (9) 819 01 00
e-mail: info@pejan.fi

France
Tel.: +33 (4) 78 34 10 14
e-mail: p.dechaume@idelum.com

Great Britain
Tel.: +44 (1926) 83 34 55
e-mail: enquire@selux.co.uk

Italy
Tel.: +39 (035) 68 38 00
e-mail: selux.italia@tiscali.it

Luxembourg
Tel.: +352 (26) 00271
Internet: http://www.selux.com

Netherlands
Tel.: +31 (165) 57 09 57
e-mail: info@selux.nl

Poland
Tel.: +48 (22) 736 73 15
e-mail: light@euro-light.pl

Portugal
Tel.: +351 (219) 748 346
e-mail: lisboa@inovodecor.com

Spain
Tel.: +34 (915) 982 660
e-mail: madrid@inovodecor.net

Sweden
Tel.: +46 (8) 54 47 09 40
e-mail: info@selux.se

Switzerland
Tel.: +41 (31) 992 98 30
e-mail: info@selux.ch

USA
Tel.: +1 (845) 691 77 23
e-mail: seluxus@selux.com

se'lux®



LUCEA®

- > INDIVIDUAL OR SYSTEM FIXTURES
- > INDIRECT/DIRECT AND INDIRECT ILLUMINATION
- > LOW PROFILE EXTRUDED ALUMINIUM
- > LASER CUT END CAPS
- > SILVER FINISH
- > DIMMABLE OPTION
- > EMERGENCY OPTIONS ON REQUEST
- > SATIN PARABOLIC LOUVRE
- > SWITCHABLE SEPARATELY
- > GLARE FREE (L<1000CD/M2 FOR $\gamma>65^\circ$)



LUCEA PENDANT - INDIRECT/DIRECT

1 x 28W Direct + 2 x 54W Indirect

SILVER	STANDARD	DIMMABLE/DALI	L	P	S	W	DATA
Individual Fixture	SX 796 013 128	SX 796 013 128/06	1428	1200mm	1500mm	8.3kg	D 4830 / I 4831
Feed-in module*	SX 796 043 128	SX 796 043 128/06	1428	1200mm	1500mm	8.3kg	D 4830 / I 4831
Mid module*	SX 796 053 128	SX 796 053 128/06	1428	1200mm	1500mm	8.3kg	D 4830 / I 4831
End module*	SX 796 063 128	SX 796 063 128/06	1428	1200mm	1500mm	8.3kg	D 4830 / I 4831

*modules require couplers - see page 6

LUCEA PENDANT - INDIRECT ONLY

2 x 54W Indirect

SILVER	STANDARD	DIMMABLE/DALI	L	P	S	W	DATA
Individual Fixture	SX 797 013 254	SX 797 013 254/06	1428	1200mm	1500mm	8.3kg	D 4831
Feed-in module	SX 797 043 254	SX 797 043 254/06	1428	1200mm	1500mm	8.3kg	D 4831
Mid module	SX 797 053 254	SX 797 053 254/06	1428	1200mm	1500mm	8.3kg	D 4831
End module	SX 797 063 254	SX 797 063 254/06	1428	1200mm	1500mm	8.3kg	D 4831

*modules require couplers - see page 6

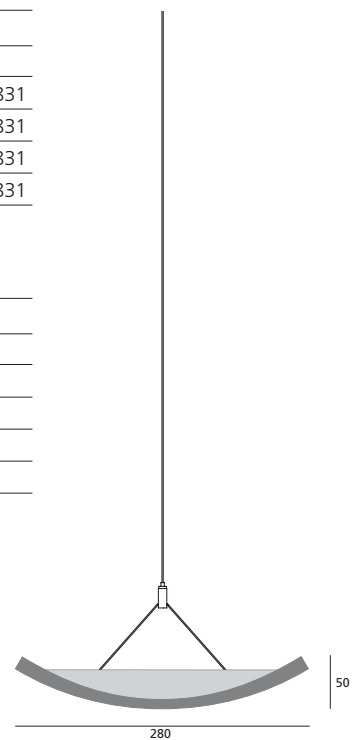

L - Length P - Fixing points S - Suspension W - Weight DATA - Photometrics on request



LUCEA® > PENDANT > AXIS PARALLEL OR MULTI-ORIENTATION FIXTURE

- > INDIRECT/DIRECT AXIS PARALLEL VERSION
- > SINGLE LUMINAIRE FOR TWO-PERSON OFFICE
- > SUITABLE FOR A WIDE RANGE OF OFFICE CONFIGURATIONS
- > IDEAL FOR OFFICES REQUIRING FLEXIBLE LAYOUTS
- > LOW PROFILE EXTRUDED ALUMINIUM
- > LASER CUT END CAPS
- > SILVER FINISH
- > DIMMABLE OPTION
- > EMERGENCY OPTIONS ON REQUEST
- > SATIN PARABOLIC LOUVRE
- > SWITCHEABLE SEPARATELY
- > GLARE FREE ($L < 1000 \text{CD/M}^2$ FOR $\gamma > 65^\circ$)



LUCEA PENDANT - INDIRECT/DIRECT AXIS PARALLEL

2 x 24W Direct + 2 x 80W Indirect

SILVER	STANDARD	DIMMABLE/DALI	L	P	S	W	DATA
Individual Fixture	SX 799 013 224	SX 799 013 224/06	2350	2120mm	1500mm	12.3kg	D 4830/ I 4831

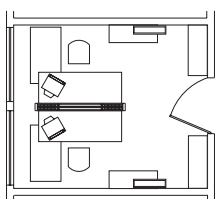

Luminaires orientated to the building's axis.
Aligning luminaires to the workplace and at right angles to the window is an especially economical way of realising architecturally sound lighting solutions. A two man office (approx. 20m²) can be adequately illuminated using just one luminaire

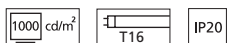
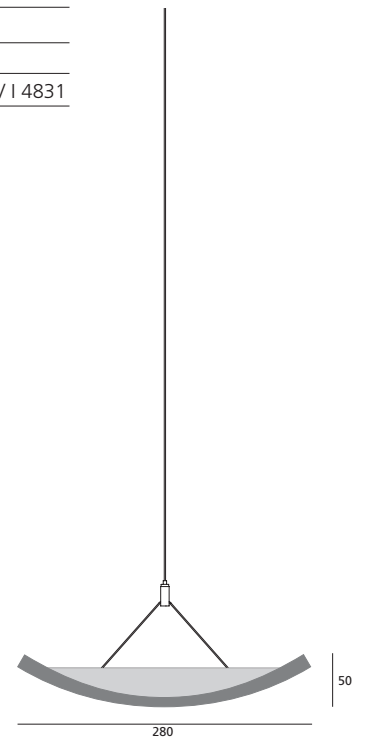

L - Length P - Fixing points S - Suspension W - Weight DATA - Photometrics on request

LUCEA® > PENDANT > INDIRECT > 3 CIRCUIT TRACK > SPOTLIGHT

- > INDIVIDUAL OR SYSTEM FIXTURES
- > INDIRECT WITH 3 CIRCUIT TRACK
- > LOW PROFILE EXTRUDED ALUMINIUM
- > LASER CUT END CAPS
- > SILVER FINISH
- > EMERGENCY OPTIONS ON REQUEST

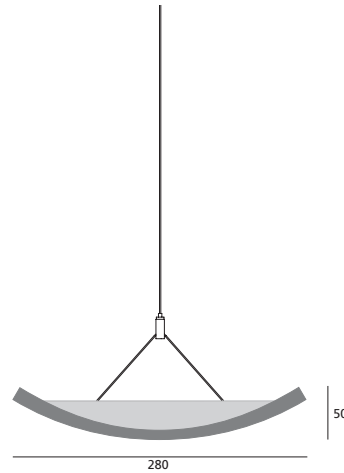

LUCEA PENDANT - INDIRECT/TRACK

2 x 54W Indirect

SILVER	STANDARD	DIMMABLE/DALI	L	P	S	W	DATA
Individual Fixture	SX 798 013 254	SX 798 013 254/06	1428	1200mm	1500mm	12.3kg	4831
Feed-in module*	SX 798 043 254	SX 798 043 254/06	1428	1200mm	1500mm	12.3kg	4831
Mid module*	SX 798 053 254	SX 798 053 254/06	1428	1200mm	1500mm	12.3kg	4831
End module*	SX 798 063 254	SX 798 063 254/06	1428	1200mm	1500mm	12.3kg	4831

*module requires couplers - see page 6

LUCEA® SPOTLIGHTS

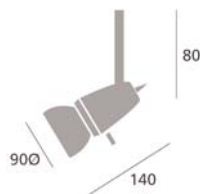

LUCEA SPOTLIGHT*

SILVER

QPAR 30 E27 max100W **SX 9-22131M**

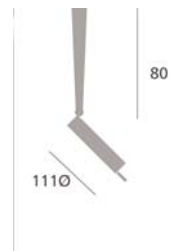

LUCEA SPOTLIGHT*

SILVER

QPAR 38 GZ10 max100W **SX 20-2070008**



L - Length P - Fixing points S - Suspension W - Weight DATA - Photometrics on request
*System OLIGO

LUCEA® > WALL MOUNTED

- > INDIRECT ASYMMETRIC
- > SILVER FINISH
- > LASER CUT END CAPS
- > DIECAST WALL BRACKETS

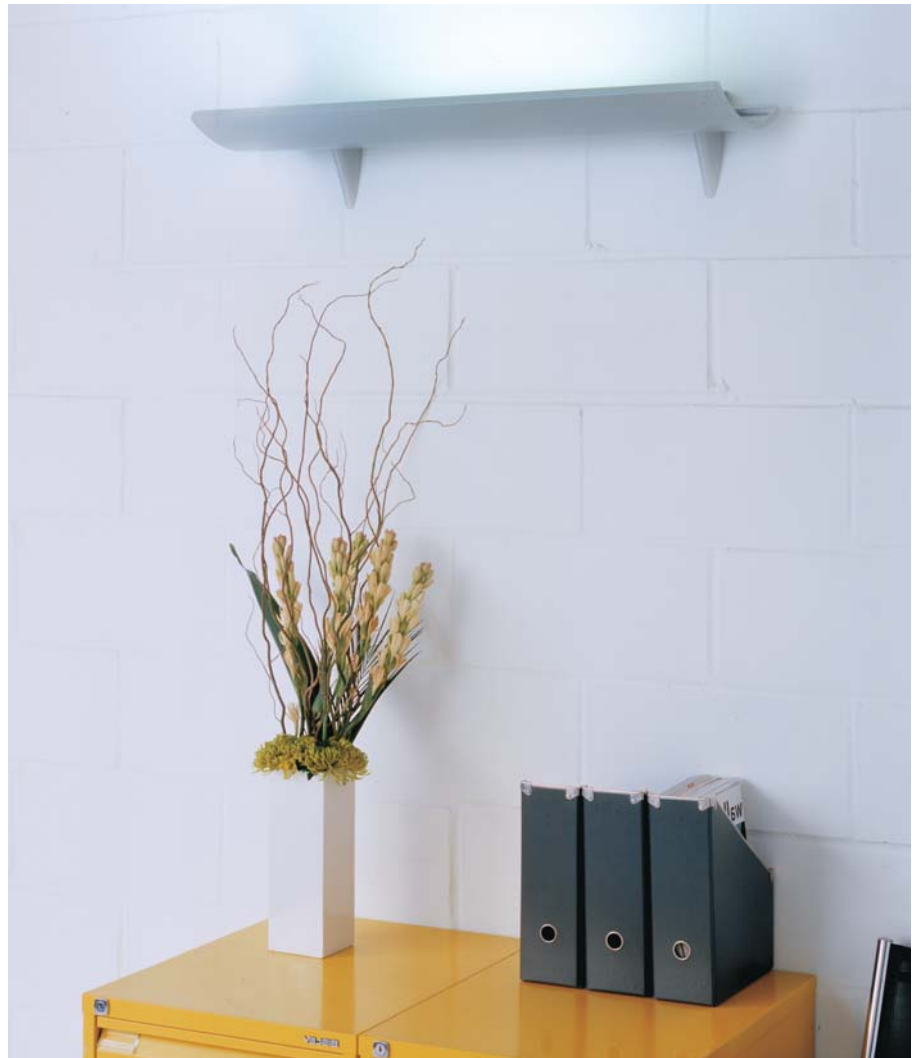

LUCEA WALL MOUNTED

TC-L 1 x 55W Indirect

SILVER		L	P	W	DATA
Standard	SX 800 013 155	890	645	6,8kg	4832
Dimmable/DALI	SX 800 013 155/06	890	645	6,8kg	4832

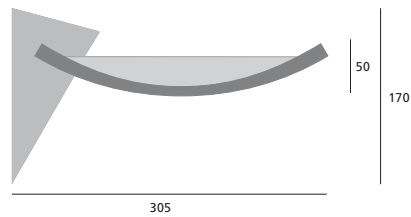

L - Length P - Fixing points W - Weight DATA - Photometrics on request

- > COUPLERS FOR SYSTEM FIXTURES
- > SILVER FINISH



LUCEA 90° COUPLER
SX 99-580-3



LUCEA VARIABLE COUPLER 90° - 270°
SX 99-581-3

